

# FULL OF HIDDEN SURPRISES



## VISITING

THE GARDNER MEMORIAL CHURCH WAS BUILT IN MEMORY OF THE REV. ALEXANDER GARDNER WHO SERVED THE PARISH OF BRECHIN FOR NEARLY 50 YEARS. THE CHURCH IS ALSO DEDICATED TO HIS LATE SON JAMES, AN EDINBURGH LAWYER AND FOUNDING MEMBER OF THE SCOTTISH RUGBY UNION, WHO DIED TRAGICALLY IN SEPTEMBER 1887.

AS PART OF A 'LINKED CHARGE' THE CONGREGATIONS OF GARDNER MEMORIAL AND FARNELL PARISH CHURCH, WHICH IS LOCATED SOME THREE MILES OUTSIDE THE TOWN, SHARE A MINISTER.

AS A WELCOMING, FRIENDLY AND GROWING CONGREGATION, OF ALL AGES AND BACKGROUNDS, WE TRY TO EXPRESS AND COMMUNICATE GOD'S LOVE IN OUR DAILY LIVES.

## ALL ARE WELCOME IN THIS PLACE

GARDNER MEMORIAL IS MANAGED BY A DEDICATED GROUP OF VOLUNTEERS. IF YOU WOULD LIKE TO JOIN US PLEASE CONTACT US AT THE CHURCH OR JOIN WITH US ON FACEBOOK GARDNERMEMORIAL

Charity No. SC008630

## INTRODUCTION

THE GARDNER MEMORIAL CHURCH WAS DESIGNED BY SIR JOHN JAMES BURNET AND BUILT BETWEEN 1896 AND 1900. BURNET WAS ONE OF SCOTLAND'S LEADING ARCHITECTS AND OVER A PERIOD OF TWENTY YEARS, DESIGNED "A FAMILY OF LONG, LOW, FRIENDLY CHURCHES" AS WELL AS A NUMBER OF OTHER SIGNIFICANT BUILDINGS NATIONALLY.

AMERICAN RURAL SHINGLE-STYLE INFLUENCES FIRST APPEARED IN BURNET'S DOMESTIC WORK AROUND 1886 AND ITS LOW-PROFILED, BIG-ROOFED STYLE SOON SPREAD TO HIS ECCLESIASTICAL WORK AS WELL.

### OTHER EXAMPLES INCLUDE;

- ST MOLIO'S, SHISKINE, ISLE OF ARRAN (1887-90) - CATEGORY A LISTED,
- DUNDAS MEMORIAL CHURCH IN GRANGEMOUTH (1894) - CATEGORY A LISTED AND
- THE BURNET FAMILY'S OWN CHURCH, BROOMHILL TRINITY CONGREGATIONAL CHURCH IN GLASGOW (1899-1907) - CATEGORY B LISTED.

ALL ARE CONSTRUCTED WITH SQUAT PYRAMID-ROOFED TOWERS WITH MIXED ROMANESQUE AND LATE GOTHIC DETAIL. THEY WERE PERCEIVED TO BE LOWER COST, EASIER TO HEAT ALTERNATIVES TO THE TALL GOTHIC REVIVAL STYLE CHURCHES.



A ROOF BEAM WITH NO STATUES ... BUT THERE ARE THREE PLINTHS?

TEL: 01356 629191  
GARDNER MEMORIAL CHURCH, SOUTHESK STREET, BRECHIN, ANGUS, DD9 6AW



## SUNDAY WORSHIP

OUR SUNDAY SERVICES START AT 11 AM AND LAST AROUND AN HOUR.

WE ARE HAPPY TO PROVIDE CRÈCHE SUPPORT FOR YOUNG VISITORS AT EVERY SERVICE AND EVERYONE IS WELCOME TO JOIN US FOR COFFEE AND A CHAT AFTERWARDS.

WHIST THE FORMAT OF OUR SERVICES IS TRADITIONAL, PREACHING AIMS TO BE LIVELY, CURRENT AND THOUGHT-PROVOKING.

## PRAY LET US LAUGH

WE ARE NOT INCLINED TO TAKE OURSELVES TOO SERIOUSLY AND PARTICIPATE ENTHUSIASTICALLY WITH BOTH LAUGHTER AND APPLAUSE WHEN APPROPRIATE.

E: OFFICE@GARDNERMEMORIALBRECHIN.ORG.UK



WE ARE VERY GRATEFUL FOR THE SUPPORT OF OUR PARTNERS AND SUPPORTERS INCLUDING:



Illustrations by Steve Pardue, www.differentia.co.uk



EN

# GARDNER MEMORIAL CHURCH

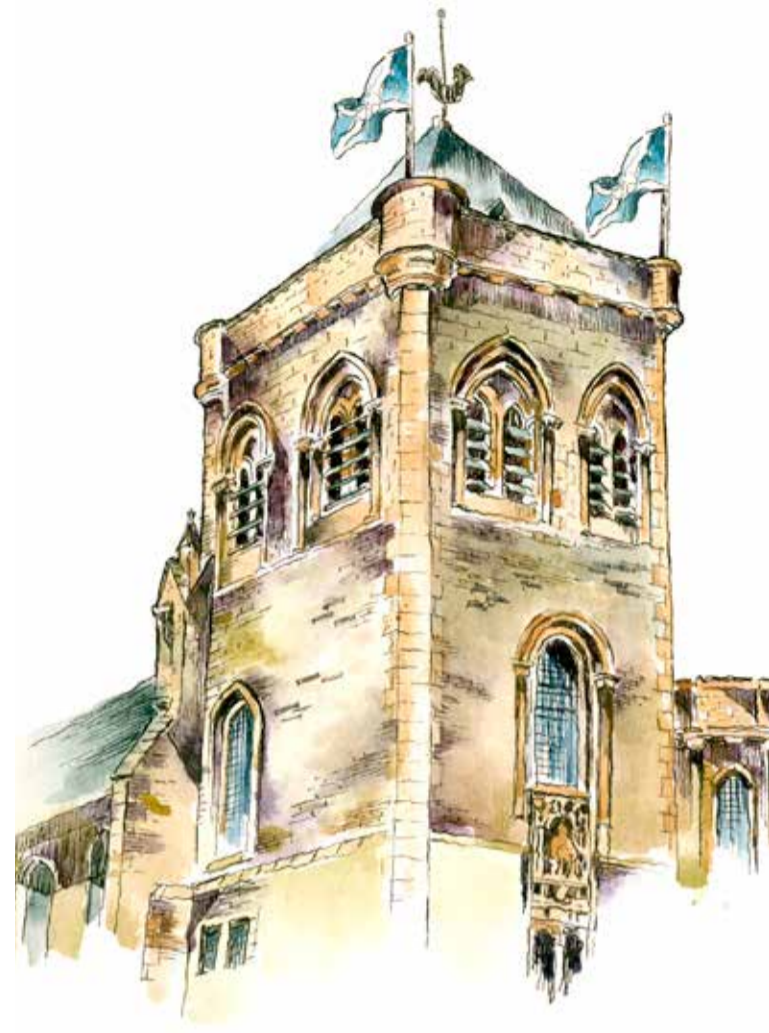

GARDNERMEMORIALBRECHIN.ORG.UK

## DETAILING

OUR CHURCH IS SIMPLE IN STYLE BUT IS FILLED WITH AN INCREDIBLE AMOUNT OF DETAIL BOTH IN THE MATERIALS AND ITS CONSTRUCTION, AND IT IS THIS DETAILING THAT IS CAPTIVATING FOR THE VISITOR AND WORSHIPPER ALIKE.

ON ENTERING THE SANCTUARY, YOU DESCEND THE STEPS TO THE CROSS AISLE EMULATING CHRIST'S DESCENT INTO THE RIVER JORDAN AND HIS BAPTISM BY JOHN THE BAPTIST. THUS WHEN ENTERING THE CHURCH, THE CONGREGATION SEEK GOD'S PRESENCE AND BLESSING.

## FONT

TO THE RIGHT OF THE STEPS, THERE IS A SMALL ALCOVE AND A LARGE MARBLE FONT. AS THE DESIGN OF THE BUILDING IS BASED ON A MEDIEVAL ANGLICAN LAYOUT, THE FONT IS POSITIONED HERE TO SIGNIFY ENTRANCE TO BOTH THE BUILDING AND THE FAITH.



## NAVES

THERE ARE THREE BAYS TO THE NAVE SUPPORTED BY THREE ORNATE PILLARS EACH WITH UNIQUE DECORATIVE CARVINGS. THE NORTH AISLE IS ALMOST THE SAME HEIGHT AS THE NAVE, BOTH HAVING SIMILAR, BUT MOST UNUSUAL AND VERY DISTINCTIVE, OPEN SCISSOR BRACED ROOFS.

## MISSING IMAGES

THROUGHOUT THE CHURCH THERE ARE A NUMBER OF EMPTY PLINTHS AND NICHES IN WHICH OTHER DENOMINATIONS MIGHT PLACE STATUES AND IMAGES.

HOWEVER, THE PRESBYTERIAN TRADITION OF THE CHURCH OF SCOTLAND SUGGESTS THAT THE DISPLAY OF SUCH IMAGES REFLECTS THE WORKMANSHIP OF MAN RATHER THAN THE CREATIONS OF THE FATHER.



## CARVINGS AND BEASTS

THE CHURCH ALSO HAS A NUMBER OF CARVINGS IN BOTH WOOD AND STONE.

THERE ARE OVER THIRTY FLORAL PATTERNS ROUND THE FRONT OF THE GALLERY. AND EIGHT ANGEL FACES AROUND THE PULPIT. SIXTEEN "CREATURES" DECORATE THE FRONT OF THE CHOIR PEWS INCLUDING A BEAR, A BUTTERFLY, AN OWL AND PERHAPS A DRAGON.



WHAT KIND OF CREATURE IS THIS?



THE DEVIL HOLDS HIS EARS ... WHY?

## UNFINISHED STONE

THROUGHOUT THE BUILDING THERE ARE VARIOUS PIECES OF UNRESSED STONEMWORK. THESE ROUGH-HEWN BLOCKS OF STONE HAVE BEEN LEFT DELIBERATELY UNFINISHED AS A REMINDER THAT THE WORK OF GOD IS NEVER FINISHED.



WHAT IS SHE THINKING?

## DETAILS AND DOORS

NOT ONLY ARE THERE IMPRESSIVE CARVINGS THROUGHOUT THE BUILDING, BUT THE DOORS ARE ALSO WORTHY OF A CLOSER INSPECTION. WHILST AT FIRST GLANCE, THEY MIGHT APPEAR TO BE COVERED WITH TOOLED LEATHER, IT IS IN FACT EQUALLY RARE TYNECASTLE TAPESTRY CREATED BY WM. SCOTT MORTON & CO OF EDINBURGH.



DETAILED STONE CARVINGS IN EVERY CORNER.

28



# GARDNER MEMORIAL CHURCH



1. Organ



2. Chancel & Rood Beam



3. Tynecastle Tapestry Doors



4. Brechin Coat of Arms

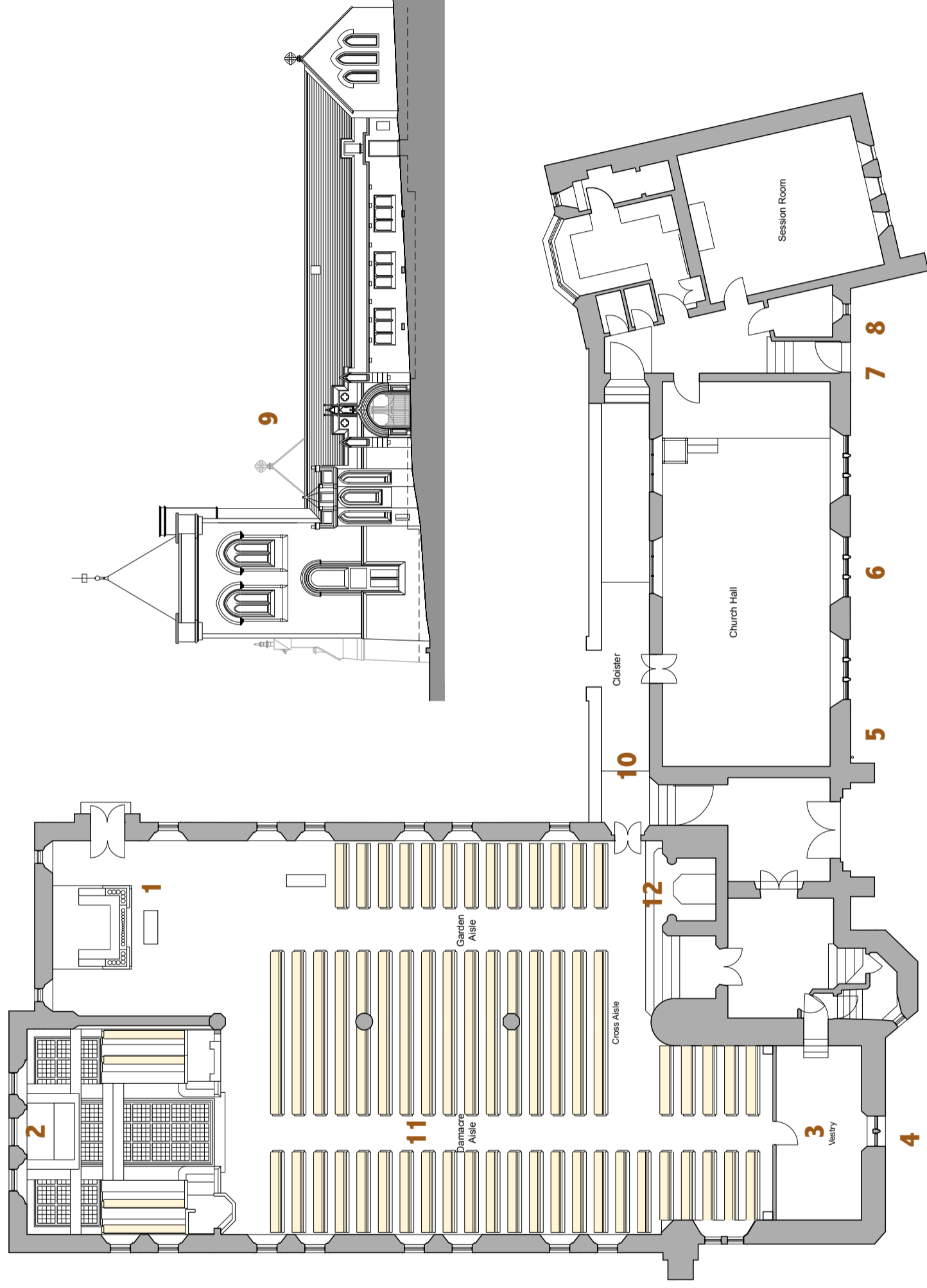

12. Marble Font



11. Scissor-braced Roof



10. Cloister Doorway



9. Empty Niche



5-8 Carved Grotesques